

JAMES M. MCINTYRE & CO.

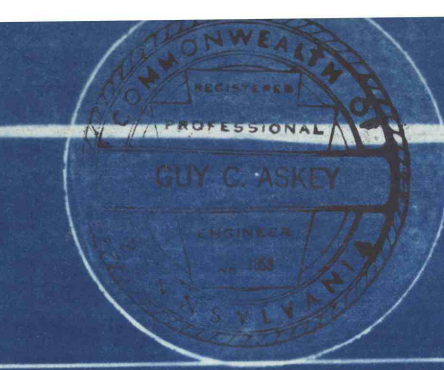

BUNKER HILL COAL CO.

# MAP OF BACON No 5 MINE

OPERATED BY  
**E. EICHELBERGER & CO.**  
Broad Top Township — Bedford County

Scale 1" = 100'  
**KELLY SEAM**  
— 1928 —

MINE	OPERATORS	REVISED
No. 5	Duval & White	SEPTEMBER 1929
No. 6	Neville & Everitts	
No. 9	W. H. Martin	

JAMES M. MCINTYRE & CO.



Note: Property Line  
This map was prepared by James M. McIntyre & Co. in 1928.