

Geo. E. Miller

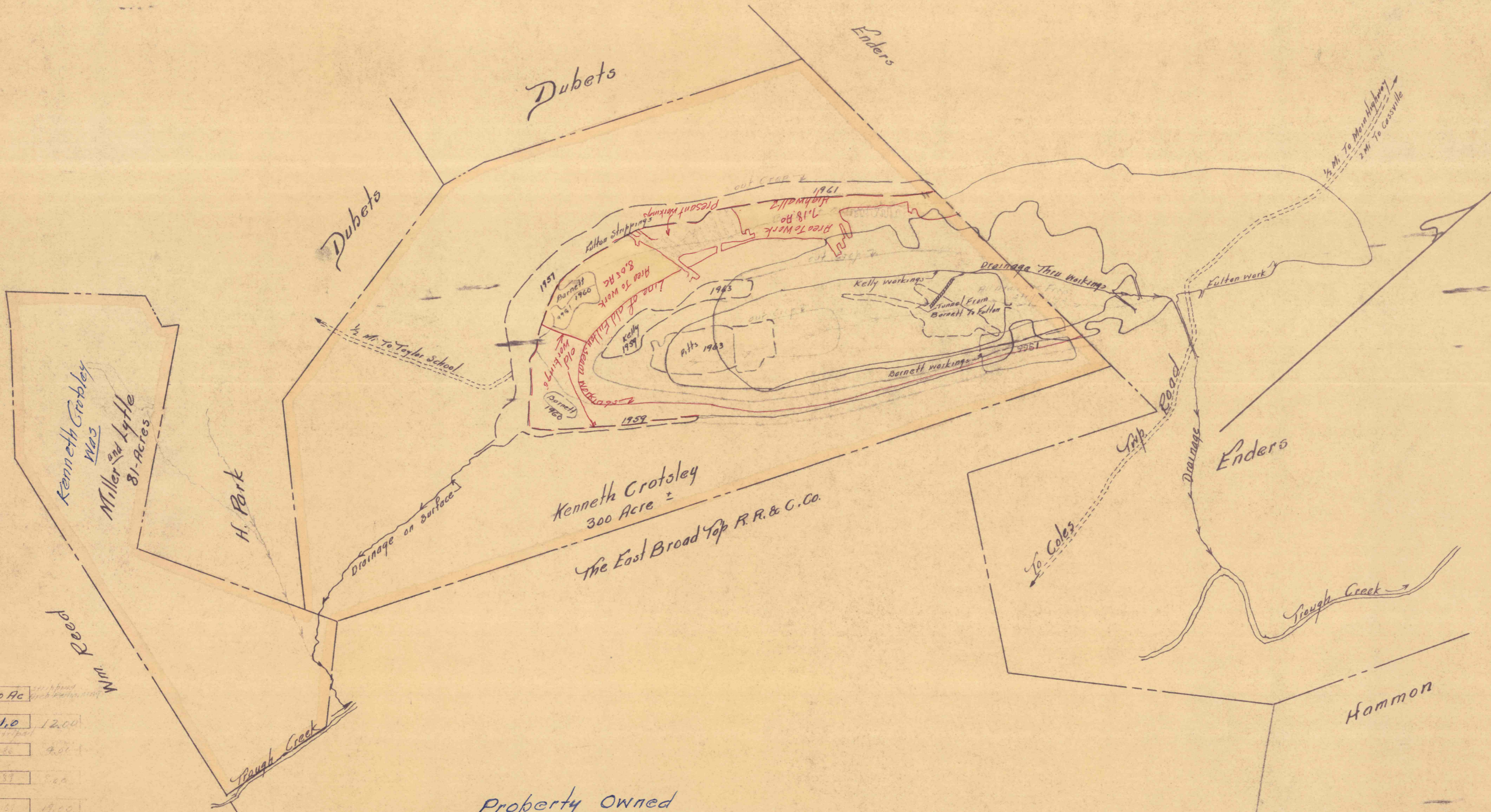

By Crottsley	300 Ac	
Miller	81.0	1200
Hs	500	900
lly	687	500
Barnett	001	1000
Fulton	1000	1275

Print Showing **Property Owned** By Ken Crottsley In Todd Twp. Huntingdon County Pennsylvania 1964 1" = 500'
 E. Corrie Engr. Robertsdale Pa.