

LEASEHOLD OF PENNSYLVANIA C. & C. CORPN.

LEASEHOLD OF PENNSYLVANIA C. & C. CORPN.

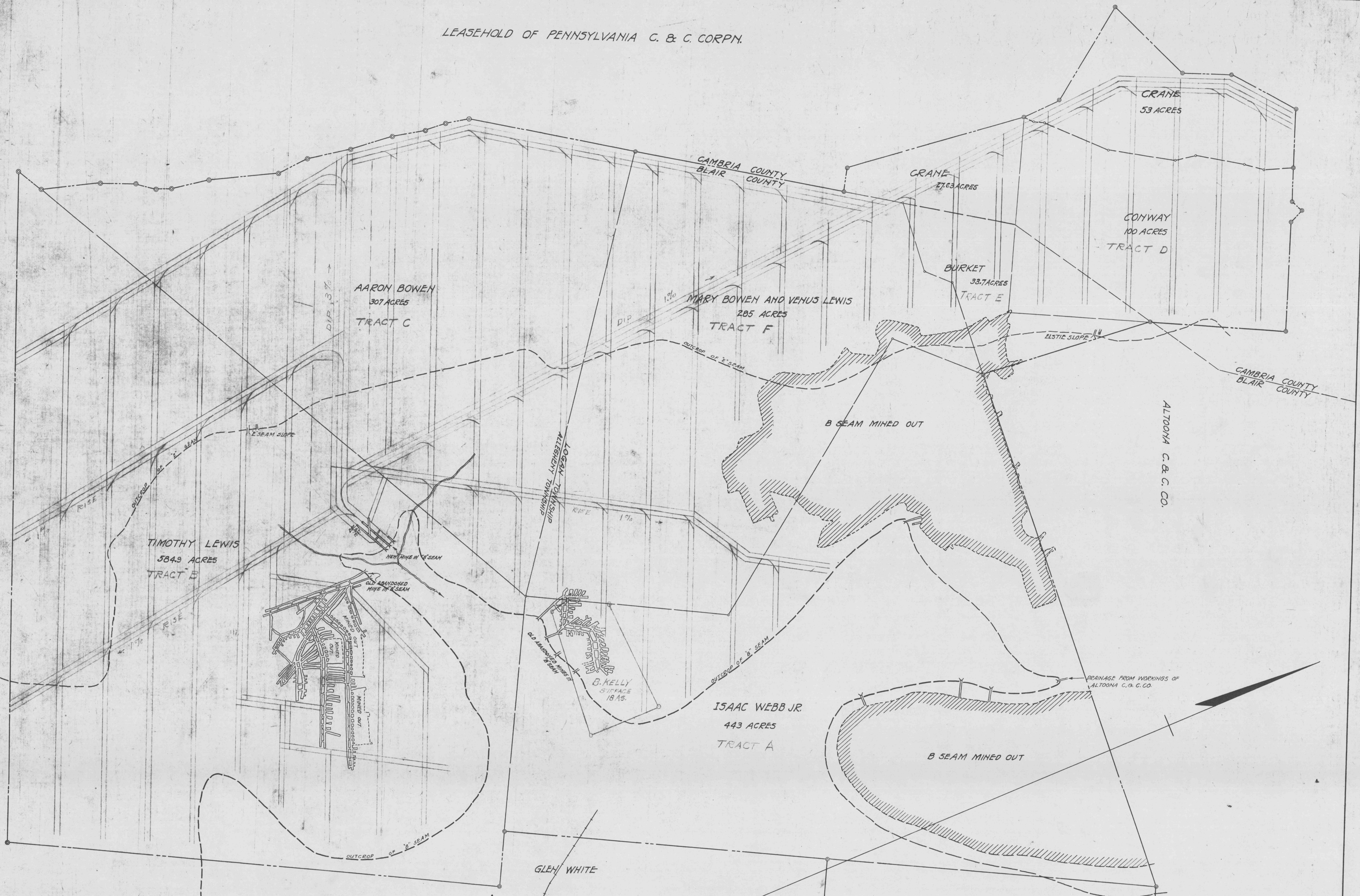

MAP OF
 "B" SEAM COAL LANDS AND MINE WORKINGS
 OF
 GLEN WHITE COAL AND LUMBER CO.
 ALLEGHENY AND LOGAN TOWNSHIPS BLAIR COUNTY
 GALLITZIN TOWNSHIP CAMBRIA COUNTY
 PENNSYLVANIA.

SCALE 1"=400'

1937

W.A. SILLIMAN,
ENGINEER.

NOTE:-
 Projected Headings, Air Courses and Manways
 to be driven in "B" Seam shown in ruled pencil lines.