

MAP of the CAMBRIA IRON CO. COAL LANDS SITUATE CRESSON TWP., CAMBRIA CO., JUNIATA AND ALLEGHENY TWPS. BLAIR CO. PENNA.

SCALE - 1 INCH = 1000 FT. DEC. 14 - 1925
JAN. 1 - 1934

NOTE:-

- AREA OWNED IN FEE
- AREA MINERALS OWNED
- AREA SURFACE ONLY
- UPPER FREEPORT OR 'E' SEAM, WORKED OUT
- LOWER KITTANNING OR 'B' SEAM, WORKED OUT

TRACED FOR **LEWIS L. GWIN**
CONSULTING ENGINEERS
TRACED BY **JOHN W. FOREMAN - MINING ENGINEER**
GORDON C. ANTHONY

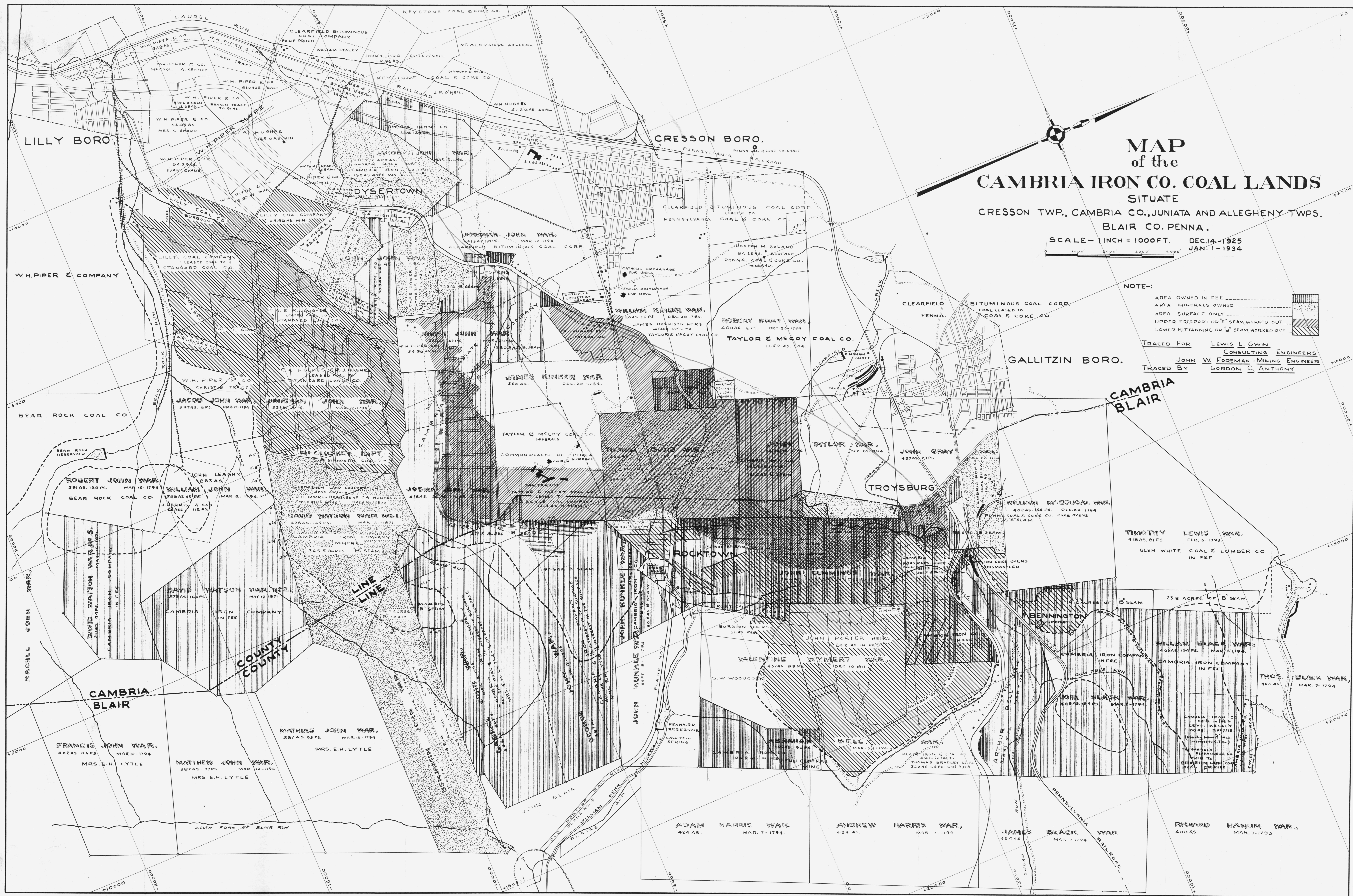

**CAMBRIA
BLAIR**

**CAMBRIA
BLAIR**

**COUNTY
COUNTY**

FRANCIS JOHN WAR,
40245.84 PS. MAR. 12-1794
MRS. E. H. LYTLE

MATTHEW JOHN WAR,
38745.37 PS. MAR. 12-1794
MRS. E. H. LYTLE

MATHIAS JOHN WAR,
38745.95 PS. MAR. 12-1794
MRS. E. H. LYTLE

ADAM HARRIS WAR,
424 AS. MAR. 7-1794.

ANDREW HARRIS WAR,
424 AS. MAR. 7-1794.

JAMES BLACK WAR,
424 AS. MAR. 7-1794.

RICHARD HANUMI WAR,
400 AS. MAR. 7-1794.

TIMOTHY LEWIS WAR,
41845.81 PS. FEB. 5-1793.
GLEN WHITE COAL & LUMBER CO.
IN FEE

WILLIAM McDOUGAL WAR,
40245.164 PS. DEC. 20-1784
PENNA. COAL & COKE CO. COKE OVENS
5'E SEAM

TROYSBURG

ROCKTOWN

JOSIAH JOHN WAR,
47845.32 PS. MAR. 12-1794

DAVID WATSON WAR NO. 1,
42845.12 PS. MAR. 12-1794
CAMBRIA IRON COMPANY
MINERAL
345.5 ACRES 'B' SEAM

DAVID WATSON WAR NO. 2,
37845.160 PS. MAY 10-1871
CAMBRIA IRON COMPANY
IN FEE

ROBERT JOHN WAR,
39145.126 PS. MAR. 12-1794
BEAR ROCK COAL CO.

WILLIAM JOHN WAR,
34645.45 PS. MAR. 12-1794
J. HARRIS & SON
126 AS. 12 AS.

JACOB JOHN WAR,
39745.6 PS. MAR. 12-1794

JONATHAN JOHN WAR,
35545.31 PS. MAR. 12-1794

JAMES KINER WAR,
350 AS. DEC. 20-1784

ROBERT GRAY WAR,
40045.6 PS. DEC. 20-1784
TAYLOR & MCGOY COAL CO.
1050.45 COAL

WILLIAM KINER WAR,
2045.15 PS. DEC. 20-1784
JAMES DENISON HEIRS
LEASER COAL TO
TAYLOR & MCGOY COAL CO.

JEREMIAH JOHN WAR,
31545.37 PS. MAR. 12-1794
CLEARFIELD BITUMINOUS COAL CORP.

JACOB JOHN WAR,
39745.6 PS. MAR. 12-1794

W.H. PIPER & COMPANY

LILLY BORO.

CRESSON BORO.

DYSERTOWN

GALLITZIN BORO.

BEAR ROCK COAL CO.

RASHILL JOHN WAR,
37845.160 PS. MAY 10-1871
CAMBRIA IRON COMPANY
IN FEE

DAVID WATSON WAR NO. 2,
37845.160 PS. MAY 10-1871
CAMBRIA IRON COMPANY
IN FEE

JOHN KUNKLE WAR,
38845.160 PS. SEPT. 8-1794
CAMBRIA IRON COMPANY
IN FEE

JOHN KUNKLE WAR,
38845.160 PS. SEPT. 8-1794
CAMBRIA IRON COMPANY
IN FEE

JOHN KUNKLE WAR,
38845.160 PS. SEPT. 8-1794
CAMBRIA IRON COMPANY
IN FEE

JOHN KUNKLE WAR,
38845.160 PS. SEPT. 8-1794
CAMBRIA IRON COMPANY
IN FEE

JOHN KUNKLE WAR,
38845.160 PS. SEPT. 8-1794
CAMBRIA IRON COMPANY
IN FEE

JOHN KUNKLE WAR,
38845.160 PS. SEPT. 8-1794
CAMBRIA IRON COMPANY
IN FEE

JOHN KUNKLE WAR,
38845.160 PS. SEPT. 8-1794
CAMBRIA IRON COMPANY
IN FEE

WILLIAM BLACK WAR,
40545.154 PS. MAR. 7-1794
CAMBRIA IRON COMPANY
IN FEE

THOS. BLACK WAR,
405 AS. MAR. 7-1794

VALENTINE WYMERT WAR,
43745.89 PS. DEC. 10-1881

JOHN PORTER HEIRS,
242 AS. IN FEE

JOHN BLACK WAR,
40545.154 PS. MAR. 7-1794

**CAMBRIA IRON CO. LEASE TO
LEVI KELLEY
(HEIR OF JOHN W. FOREMAN & SONS
MINING CO.)**

**CAMBRIA IRON CO. LEASE TO
BENJAMIN LANG COKE
& LUMBER CO.**

MATTHEW JOHN WAR,
38745.37 PS. MAR. 12-1794
MRS. E. H. LYTLE

MATHIAS JOHN WAR,
38745.95 PS. MAR. 12-1794
MRS. E. H. LYTLE

JOHN KUNKLE WAR,
38845.160 PS. SEPT. 8-1794
CAMBRIA IRON COMPANY
IN FEE

JOHN KUNKLE WAR,
38845.160 PS. SEPT. 8-1794
CAMBRIA IRON COMPANY
IN FEE

JOHN KUNKLE WAR,
38845.160 PS. SEPT. 8-1794
CAMBRIA IRON COMPANY
IN FEE

JOHN KUNKLE WAR,
38845.160 PS. SEPT. 8-1794
CAMBRIA IRON COMPANY
IN FEE

JOHN KUNKLE WAR,
38845.160 PS. SEPT. 8-1794
CAMBRIA IRON COMPANY
IN FEE

JOHN KUNKLE WAR,
38845.160 PS. SEPT. 8-1794
CAMBRIA IRON COMPANY
IN FEE

JOHN KUNKLE WAR,
38845.160 PS. SEPT. 8-1794
CAMBRIA IRON COMPANY
IN FEE

WILLIAM BLACK WAR,
40545.154 PS. MAR. 7-1794
CAMBRIA IRON COMPANY
IN FEE

THOS. BLACK WAR,
405 AS. MAR. 7-1794

VALENTINE WYMERT WAR,
43745.89 PS. DEC. 10-1881

JOHN PORTER HEIRS,
242 AS. IN FEE

JOHN BLACK WAR,
40545.154 PS. MAR. 7-1794

**CAMBRIA IRON CO. LEASE TO
LEVI KELLEY
(HEIR OF JOHN W. FOREMAN & SONS
MINING CO.)**

**CAMBRIA IRON CO. LEASE TO
BENJAMIN LANG COKE
& LUMBER CO.**