

CAMBRIA COUNTY  
BLAIR COUNTY

COMM. OF PENNA

THOMAS BOND

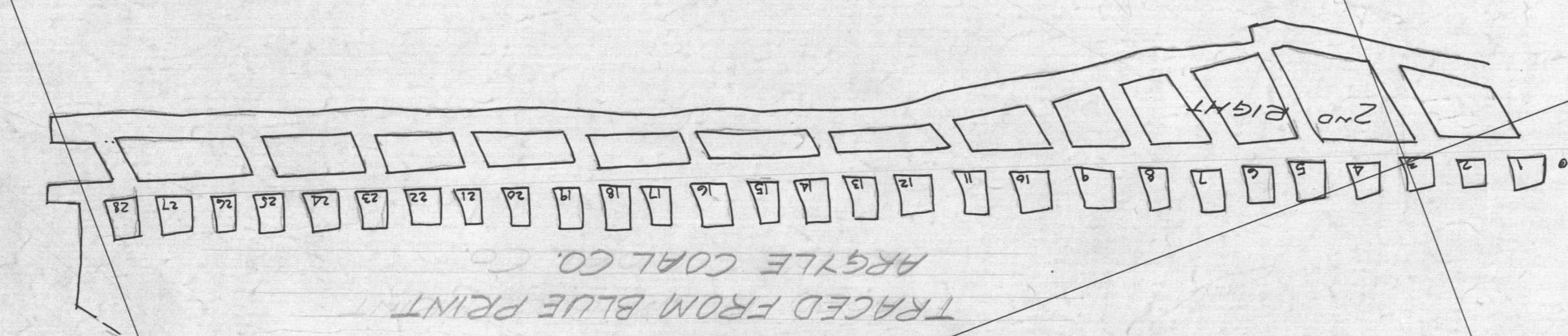

AREA MINED OUT ROOMS



JOHN KUNKLE

JOHN CUMMINGS

GEO JOHN

MINED OUT

MINED OUT

MINED OUT PRIOR TO 1900  
(INFORMATION FROM AGED RESIDENTS)

MINED OUT

STONE BRIDGE COAL CO.  
CRESSON PA.  
SCALE 1"=100' AUG. 24, 1938.

TRACED & COORDINATED FROM A  
BLUE PRINT OF THE BETHLEHEM STEEL CO.  
S.W. DULCES.

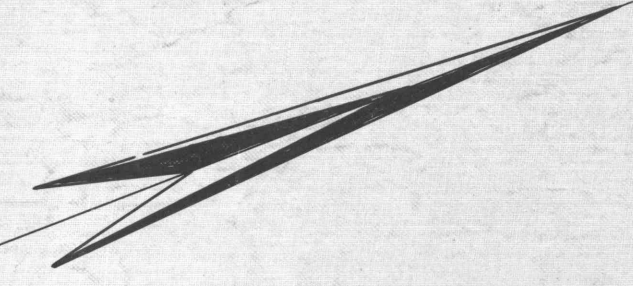

E 7000

S 5000

S 3000

E 8000

S 2000

S 1000

0000

N 10000

C7D10-1