

NOTE:

THE LATEST AVAILABLE MINE MAPS ARE DATED MARCH 20TH 1919.
OUTLINES OF WORKINGS SHOWN ARE TO THAT DATE ONLY.
KELLY SEAM AREAS MINED OVER MARKED WITH DIAGONAL LINES.
BARNETT SEAM AREAS MINED OVER BORDERED WITH HEAVY SHADING.

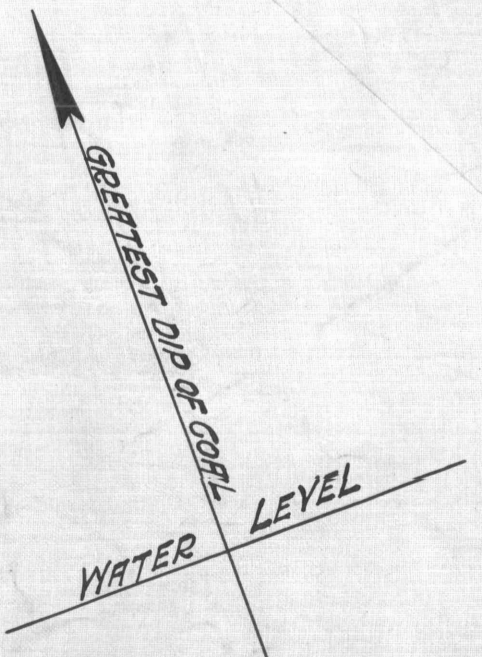
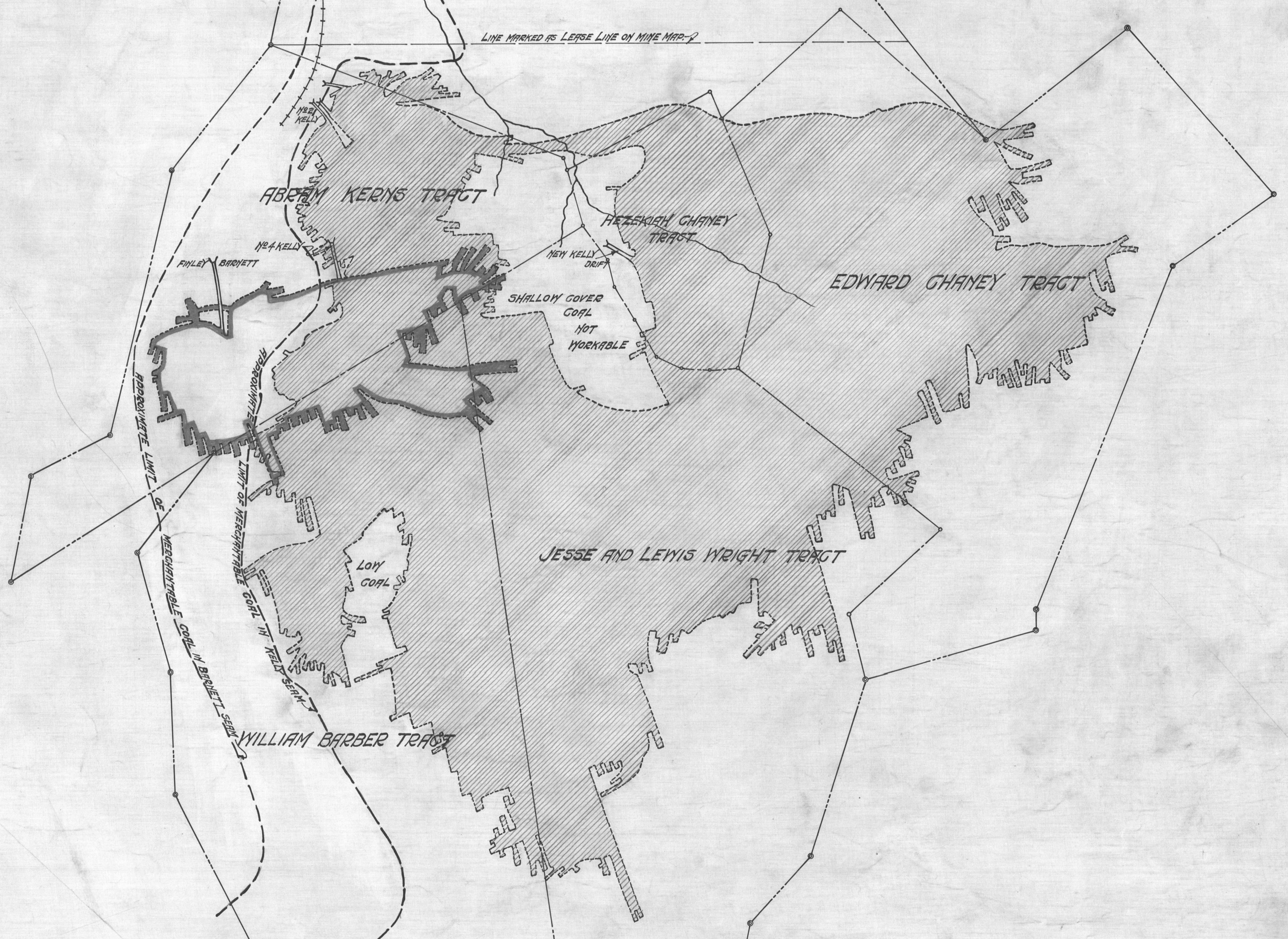
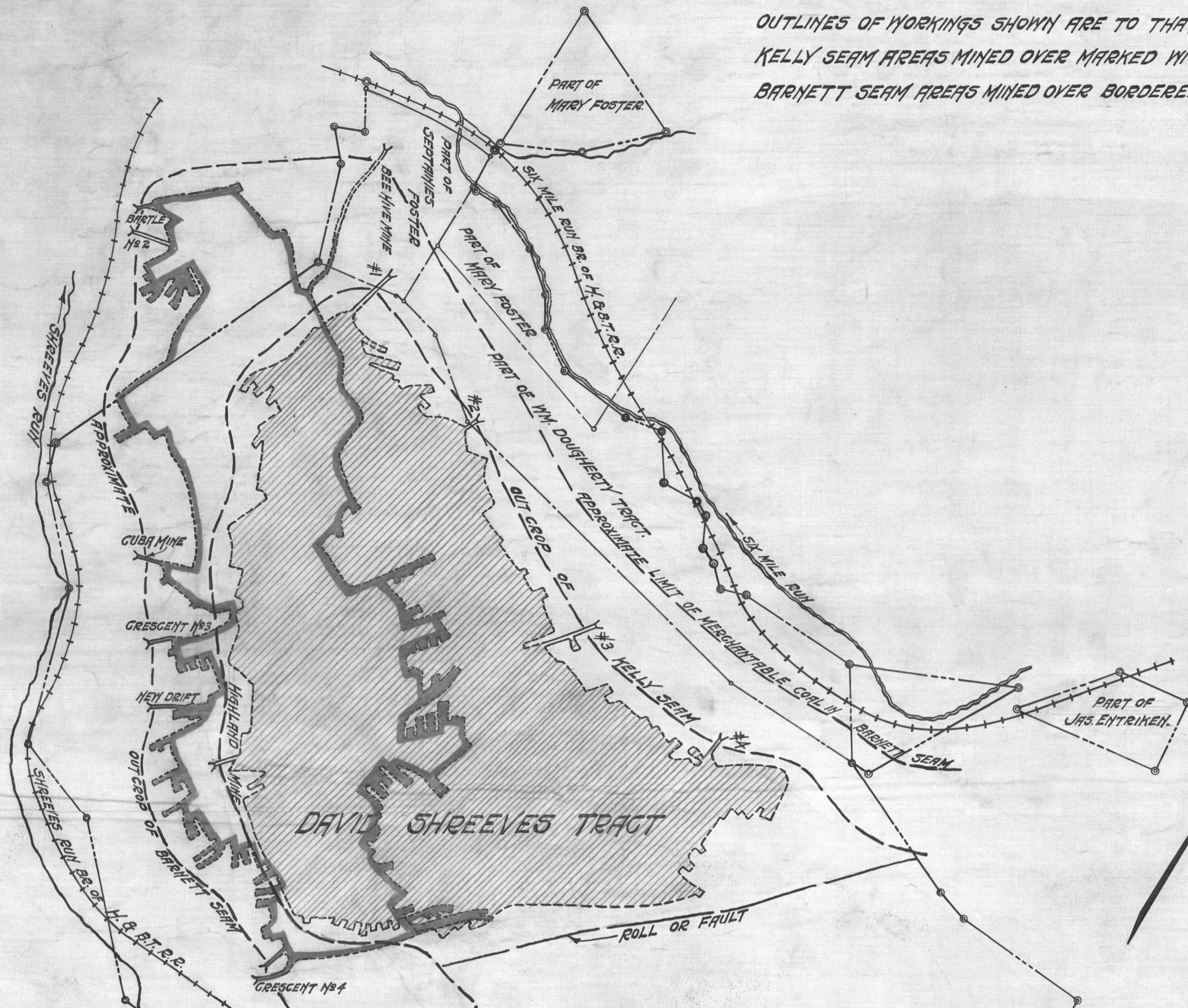

MAP SHOWING AREAS MINED OVER

IN KELLY AND BARNETT COAL SEAMS

ON PROPERTY OF THE

SIX MILE RUN COAL CO.

BROAD TOP TOWNSHIP, BEDFORD COUNTY, PA.

SCALE: -1"=400'

MARCH 10TH 1920

J.S. SILLIMAN & CO.
ENGINEERS
ALTOONA, PA.

COMPILED FROM LAND MAP BY G.W. CUNARD AND MINE MAPS BY WOMELSDORFF & DUNKEL.

887-1 17016-2