

NOTE:

THE LATEST AVAILABLE MINE MAPS ARE DATED MARCH 20TH 1919.  
OUTLINES OF WORKINGS SHOWN ARE TO THAT DATE ONLY.

KELLY SEAM AREAS MINED OVER MARKED WITH DIAGONAL LINES.  
BARNETT SEAM AREAS MINED OVER BORDERED WITH HEAVY SHADING.

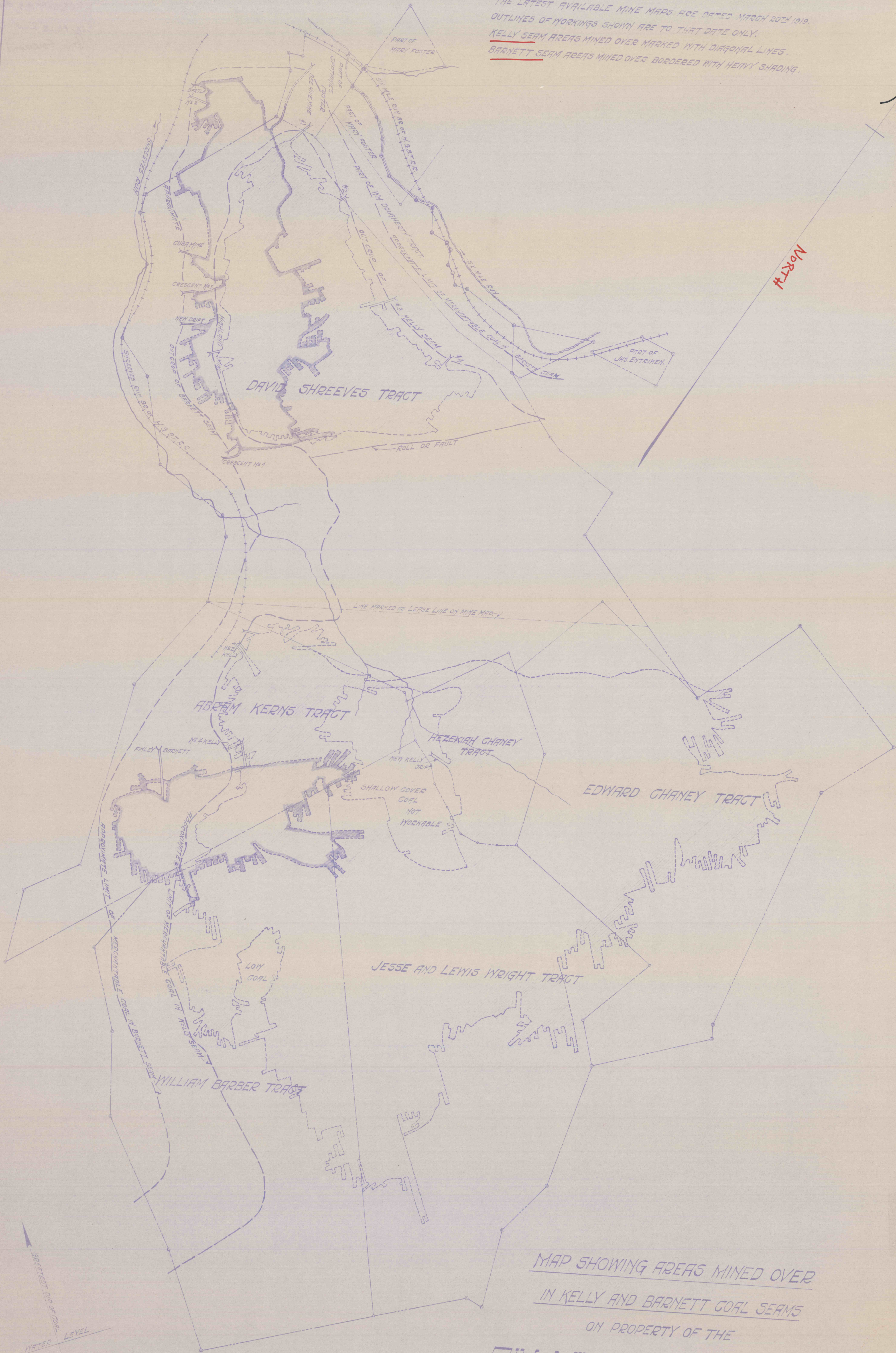

MAP SHOWING AREAS MINED OVER  
IN KELLY AND BARNETT COAL SEAMS  
ON PROPERTY OF THE

**SIX MILE RUN COAL CO.**

BROAD TOP TOWNSHIP, BEDFORD COUNTY, PA.

SCALE: 1" = 400'

MARCH 10TH 1920

J.S. SULLIVAN & CO.  
ENGINEERS  
ALTOONA, PA.

COMPILED FROM LAND MAP BY G.W. GUNARD AND MINE MAPS BY WOMELEDORFF & DUNKEL